

TSSLS-CBDEE3T Optical Transceiver

25G SFP28 BIDI Single-mode Transceiver, With Diagnostic Monitoring
Duplex SFP28 10km Transceiver

Features

- Class 1 laser safety certified
- Operating data rate up to 25.78Gbps
- Up to 10km transmission distance
- High sensitivity PIN photodiode and TIA
- LC single connector
- Hot pluggable 20pin connector
- Low power consumption <1.5W
- -40°C to 85°C operating wide temperature range
- Single +3.3V±5% power supply
- Digital Monitoring SFF-8472 compliant
- Fully RoHS Compliant 

Applications

- 25GE LR
- CPRI Option 10/e CPRI

Product Description

The SFP28 Transceiver is designed for use in Ethernet/eCPRI/ CPRI links up to 25.78 Gb/s data rate and up to 10 km link length.

They are compliant with SFF8472, SFF-8431, SFF-8432. Digital diagnostics functions are available via a 2-wire serial interface, as specified in SFF-8472.

Absolute Maximum Ratings

These values represent the damage threshold of the module. Stress in excess of any of the individual Absolute Maximum Ratings can cause immediate catastrophic damage to the module even if all other parameters are within Recommended Operating Conditions.

Parameters	Symbol	Min.	Max.	Unit
Power Supply Voltage	VCC	-0.5	+4.0	V
Storage Temperature	T _s	-40	+85	°C
Relative Humidity	RH	0	95	%

Recommended Operating Conditions

Parameter	Symbol	Min	Typical	Max	Unit
Supply Voltage	VCC	3.14	3.3	3.46	V
Operating Case Temperature	T _c	-40	-	85	°C

Notes:

[1] Supply current is shared between VCCTX and VCCR_X.

[2] In-rush is defined as current level above steady state current requirements.

Electrical Characteristics

Parameter	Symbol	Min.	Typical	Max	Unit	Ref.
Transmitter						
Data Rate	BR		25.78	-	Gbps	
Input differential impedance	R _{IN}	90	100	110	Ω	1
Single-ended Data Input Swing	V _{IN}	90	-	450	mV _{p-p}	
Transmit Disable Voltage	V _{DIS}	2.0	-	V _{CCHOST}	V	
Transmit Enable Voltage	V _{EN}	V _{EE}		V _{EE} +0.8	V	2
Transmit Fault Assert Voltage	V _{fa}	2.0	-	V _{CCHOST}	V	
Transmit Fault De-Assert Voltage	V _{FDA}	V _{EE}		V _{EE} +0.4	V	
Receiver						
Data Rate	BR	-	25.78	-	Gbps	
Output differential impedance	R _{out}	90	100	110	Ω	1
Single-ended Data Output Swing	V _{OD}	200	-	450	mV _{p-p}	
LOS Fault	V _{LOSFT}	2.0	-	V _{CCHOST}	V	
LOS Normal	V _{LOSNR}	V _{EE}		V _{EE} +0.4	V	

Notes:

[1] AC coupled.

[2] Or open circuit.

Transmitter Specifications – Optical

Parameter	Symbol	Min	Typical	Max	Unit
Center Wavelength	λ	1260	1270	1280	nm
Side Mode Suppression Ratio	SMSR	30	-	-	dB
Average Optical Power	P_o	-3	-	5	dBm
Extinction Ratio	ER	3.5			dB
Average Launch Power of OFF Transmitter	P_{OFF}	-	-	-30	dBm
Relative Intensity Noise	R_{IN}			-130	dB/Hz

Receiver Specifications – Optical

Parameter	Symbol	Min	Typical	Max	Unit
Center Wavelength	λ	1320	1330	1340	nm
Receiver sensitivity[1]	R_{SEN}	-	-	-13	dBm
Receiver Overload	P_{MAX}	2.2			dBm
Optical Return Loss	R_{RL}	-	-	-26	dB
LOS Asserted	L_{SA}	-30	-	-	dBm
LOS De-Asserted	L_{DA}	-	-	-17	dBm
LOS Hysteresis	L_H	0.5	-	-	dB

Notes:

[1] Measured at 25.78125Gb/s, ER>3.5dB, PRBS 231- 1 and BER better than or equal to 5E-5

Sfp28 Transceiver Electrical Pad Layout

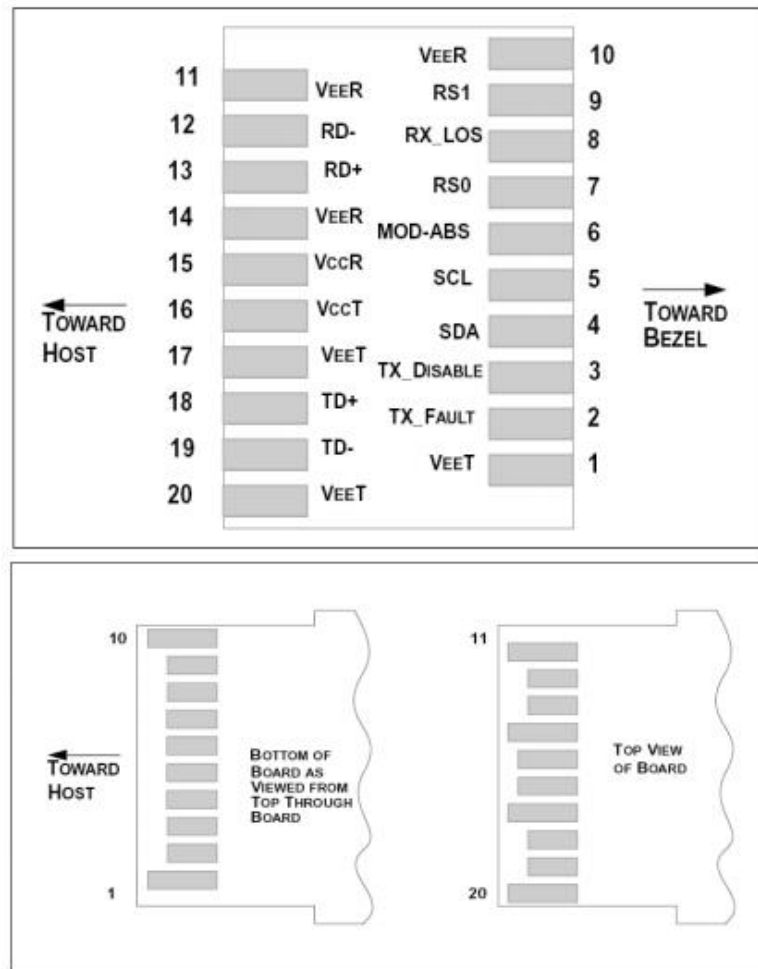

Pin Definition

Pin	Symbol	Name/Description
1	VEET [1]	Transmitter Ground
2	Tx_FAULT [2]	Transmitter Fault
3	Tx_DIS [3]	Transmitter Disable. Laser output disabled on high or open
4	SDA [2]	2-wire Serial Interface Data Line
5	SCL [2]	2-wire Serial Interface Clock Line
6	MOD_ABS [4]	Module Absent. Grounded within the module
7	RS0 [5]	Rate Select 0
8	RX_LOS [2]	Loss of Signal indication. Logic 0 indicates normal operation
9	RS1 [5]	Rate Select 1
10	VEER [1]	Receiver Ground
11	VEER [1]	Receiver Ground
12	RD-	Receiver Inverted DATA out. AC Coupled

Information and specifications are subject to change without notice.
Please visit www.china-tscom.com for more information

8 Jinxiu Middle Road, Pingshan, Shenzhen, Guangdong, 518118, P. R. China
+86 755 32983688 | info@china-tscom.com | www.china-tscom.com



13	RD+	Receiver DATA out. AC Coupled
14	VEER [1]	Receiver Ground
15	VCCR	Receiver Power Supply
16	VCCT	Transmitter Power Supply
17	VEET [1]	Transmitter Ground
18	TD+	Transmitter DATA in. AC Coupled
19	TD-	Transmitter Inverted DATA in. AC Coupled
20	VEET [1]	Transmitter Ground

Notes:

[1] Module circuit ground is isolated from module chassis ground within the module.

[2] Should be pulled up with 4.7k – 10k ohms on host board to a voltage between 3.15V and 3.6V.

[3] Tx_Disable is an input contact with a 4.7 kΩ to 10 kΩ pullup to VCCT inside the module.

[4] Mod_ABS is connected to VeeT or VeeR in the SFP+ module. The host may pull this contact up to VCC_Host with a resistor in the range 4.7 kΩ to 10 kΩ. Mod_ABS is asserted “High” when the SFP+ module is physically absent from a host slot.

[5] RS0 and RS1 are module inputs and are pulled low to VeeT with > 30 kΩ resistors in the module.

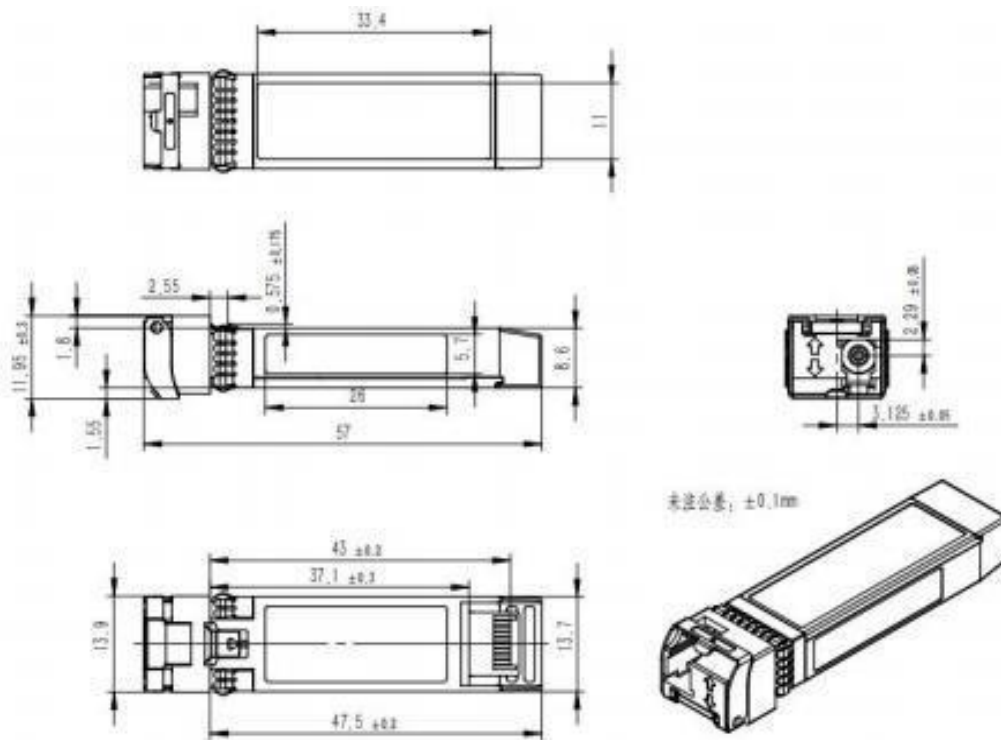
Mechanical

Ordering Information

Part Number	Product Description
TSSLS-CBDEH7T	25Gbps SFP28 40km Transceiver, -40°C ~ +85°C, Laser 1270nm; Receiver 1330nm;

Important Notice

Performance figures, data and any illustrative material provided in this data sheet are typical and must be specifically confirmed in writing by T&S before they become applicable to any particular order or contract. In accordance with the T&S policy of continuous improvement specifications may change without notice.

The publication of information in this data sheet does not imply freedom from patent or other protective rights of T&S or others. Further details are available from any T&S sales representative.